

HEAT-TIMER

SOLENOID VALVES

These general purpose 2-way solenoid valves are for use with neutral liquids. The valves are based on more than 50 years experience in the design, production, and application of high quality solenoid valves. The valves are Normally Closed (closed when de-energized). They are soft closing (anti-water hammer). The bodies are brass (except for the 2" valve, which is gun metal). The valves can work with a wide range of water temperatures from -25°F to 245°F with a maximum ambient temperature of 120°F.

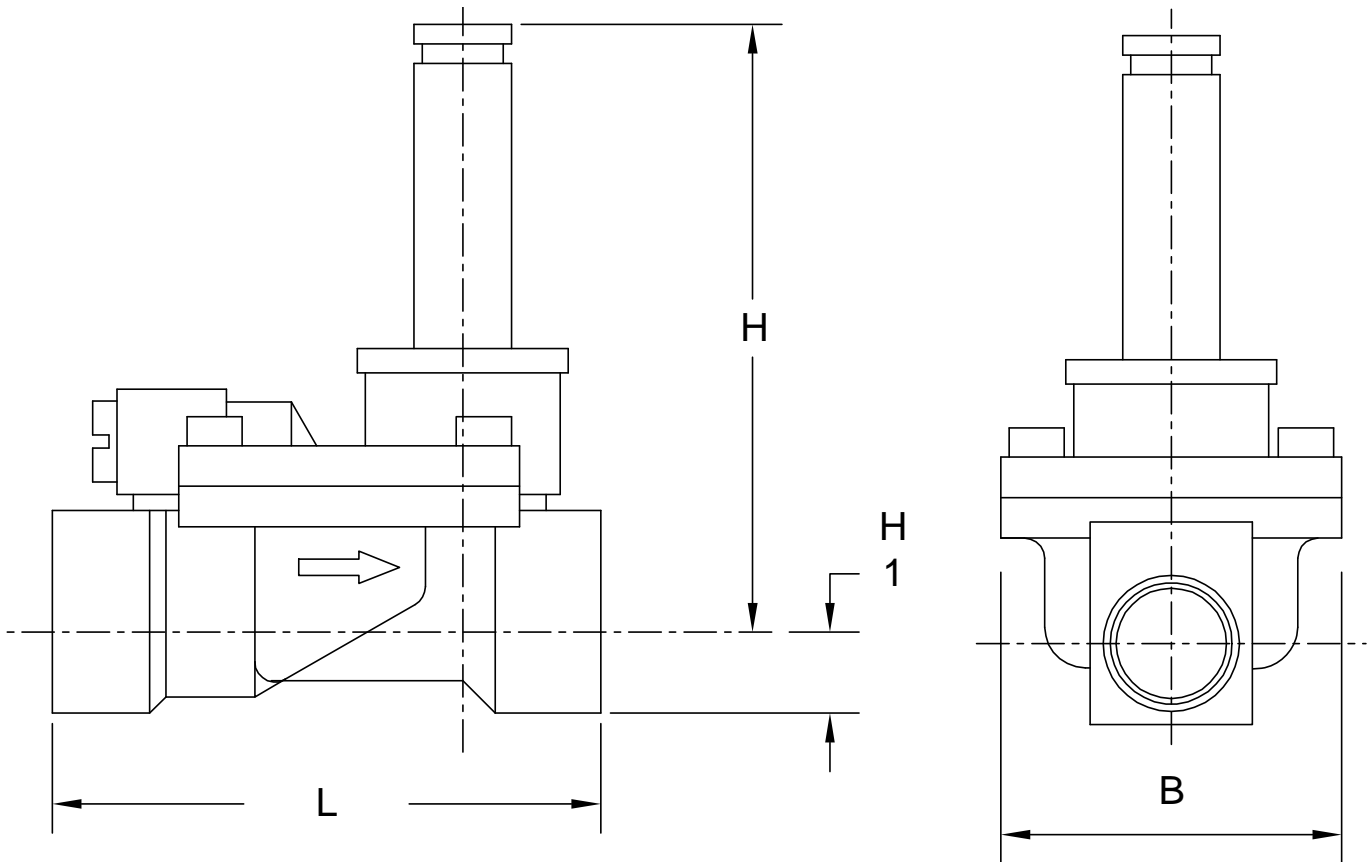

Valve Size (Inches)	Catalog Number	Cv Value (G.P.M.)	Opening Differential		Safe Working Pressure (P.S.I.)	Opening Time (Sec)	Closing Time (Sec)	Valve Dimensions				
			Min (P.S.I.)	Max (P.S.I.)				L (Inches)	B (Inches)	H1 (Inches)	H (Inches)	NPT Tapping
1/2	920520	4.6	4	142	225	0.04	0.35	3 3/8	2 1/16	9/16	3 11/16	1/2
3/4	920521	9.3	4	142	225	0.04	1.00	3 11/16	2 1/4	11/16	3 7/8	3/4
1	920522	12.3	4	142	180	0.30	1.00	4 9/16	2 3/4	7/8	4 1/4	1
1 1/4	920523	21	4	142	180	1.00	2.50	4 13/16	3 1/4	1 1/16	4 1/2	1 1/4
1 1/2	920524	28	4	142	180	1.50	4.00	5 3/16	3 3/4	1 1/4	4 7/8	1 1/2
2	920525	46.7	4	142	180	5.00	10.00	6 3/8	4 7/16	1 7/16	5 1/8	2

INSTALLATION

Piping

- The valve has NPT connections.
- The valve is Normally Closed. Water will not flow through the valve until the coil is energized (see WIRING below).
- Install the valve so the arrow (marked 1 on the diagram) on the valve body is in the direction of flow.
- Be sure to leave enough clearance in front of the armature (2) to install the solenoid coil (3).
- **DO NOT** position the armature underneath the valve body.

Installing the Solenoid Coil

- Slide the solenoid coil (3) over the armature (2) so the metal tab (4) faces away from the valve body.
- Slide the metal ring (6) over the coil.
- Secure the coil and ring to the armature with the plastic clip (7) and nut (8).

Wiring the Solenoid Coil

- Remove the cover (5) from the solenoid coil junction box.
- The solenoid coil will be energized (and open the valve) when 110V is applied across the wires in the junction box.

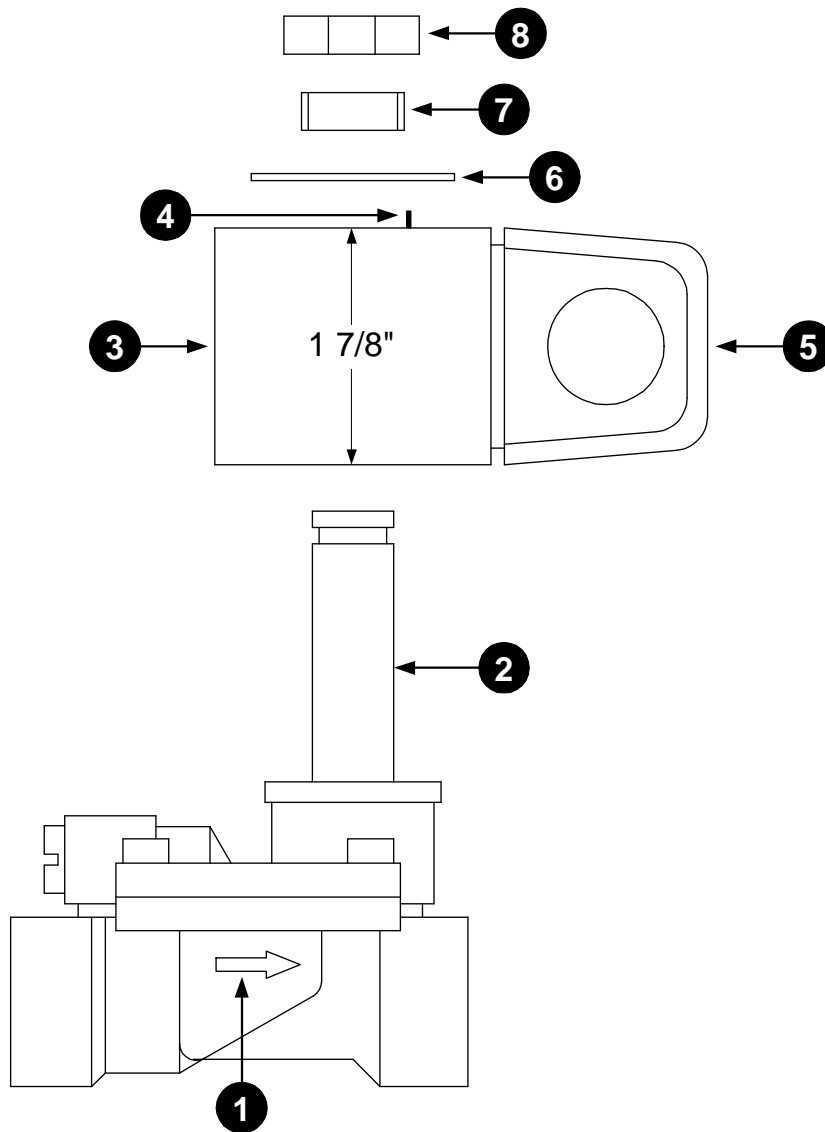

For Technical Support of Additional Product Information Contact:

Heat-Timer Corporation

20 New Dutch Lane

Fairfield, NJ 07004

Phone (973) 575-4004 Fax (973) 575-4052